



INSTALLATION INSTRUCTIONS

CONNECTORS for Radiating Cables

Kabelwerk | **EUPEN** AG

Rev.03/2017-06-09

cable

Connectors for RC-400 Radiating Cable

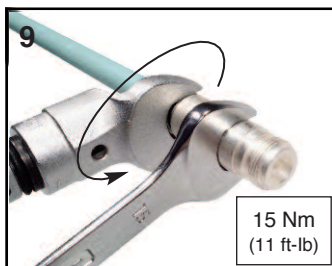
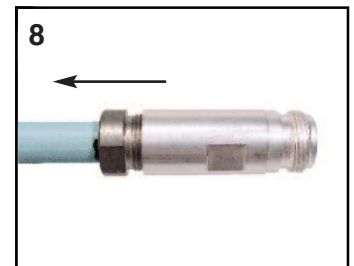
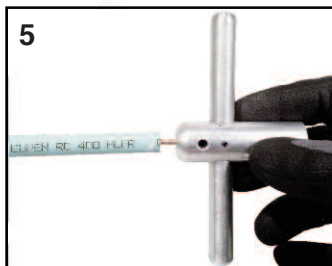
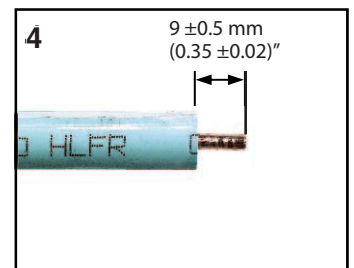
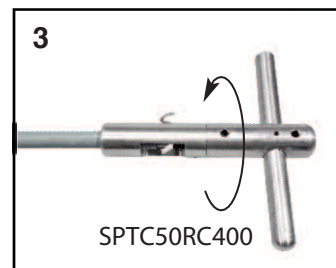
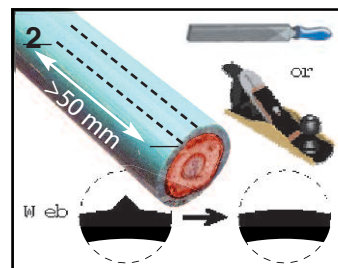
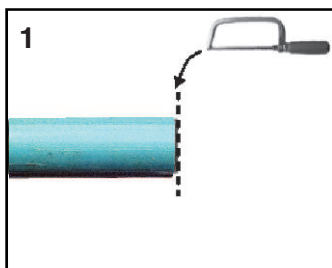
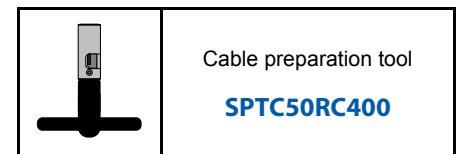
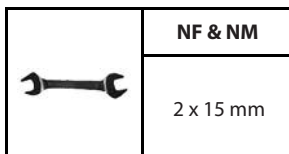

1* For installations in harsh environments, the use of an optional Heat-Shrink is recommended.

For any questions please contact KABELWERK EUPEN AG / for US Customer service call 1-800-419-5100

(D) Verarbeitung nur durch eine Elektrofachkraft.
Es besteht die Gefahr eines elektrischen Schlages!

(F) Installation uniquement par une personne qualifiée en électricité.
Il y a un risque de choc électrique!



(NL) Installatie alleen door een vakman voor elektriciteit.
Er is gevaar van elektrische schok!

(GB) Processing only by a qualified electrician.
There is a risk of electric shock!

NOTICE:
KABELWERK EUPEN AG disclaims any liability or responsibility for the results of improper or unsafe installation practices.

AVIS:
KABELWERK EUPEN AG décline toute responsabilité en cas de non respect de ces instructions.

WAARSCHUWING:
KABELWERK EUPEN AG wijst elke verantwoordelijkheid van de hand in geval van het niet opvolgen van deze aanbevelingen.

BEMERKUNG:
KABELWERK EUPEN AG lehnt jede Verantwortung bei Nichtbeachtung dieser Instruktionen ab.

AVISO:
KABELWERK EUPEN AG rehusa todas las responsabilidades en caso de no respetar las instrucciones.

注意:
本公司声明对于不恰当或不安全的安装, 检验, 维修或拆卸操作所导致的后果不负任何义务和责任。