

### 1/2" - Straight & right angle connectors - O-Ring type

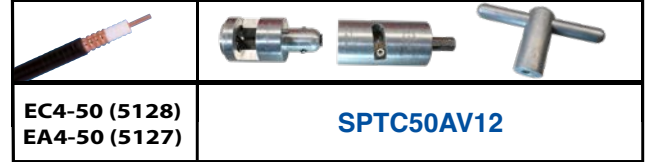

Please use the cable preparation tool SPTC50AV12 and refer to its instructions for use.

Follow the instruction process below only if the tool SPTC50AV12 is not available.



	NF, NM	NM50VL12	4.1/9.5M	4.3/10M N1	7/16M N1	43MVL12	7/16MVL12	7/16F N1 4.3/10F N1
	2 x 19 mm	19 mm & 23 mm	2 x 19 mm & 22 mm	19 mm & 21 mm & 22 mm	19 mm & 21 mm & 32 mm	22 mm & 19 mm	19 mm & 24 mm & 32 mm	19 mm & 21 mm

#### MANUAL METHOD

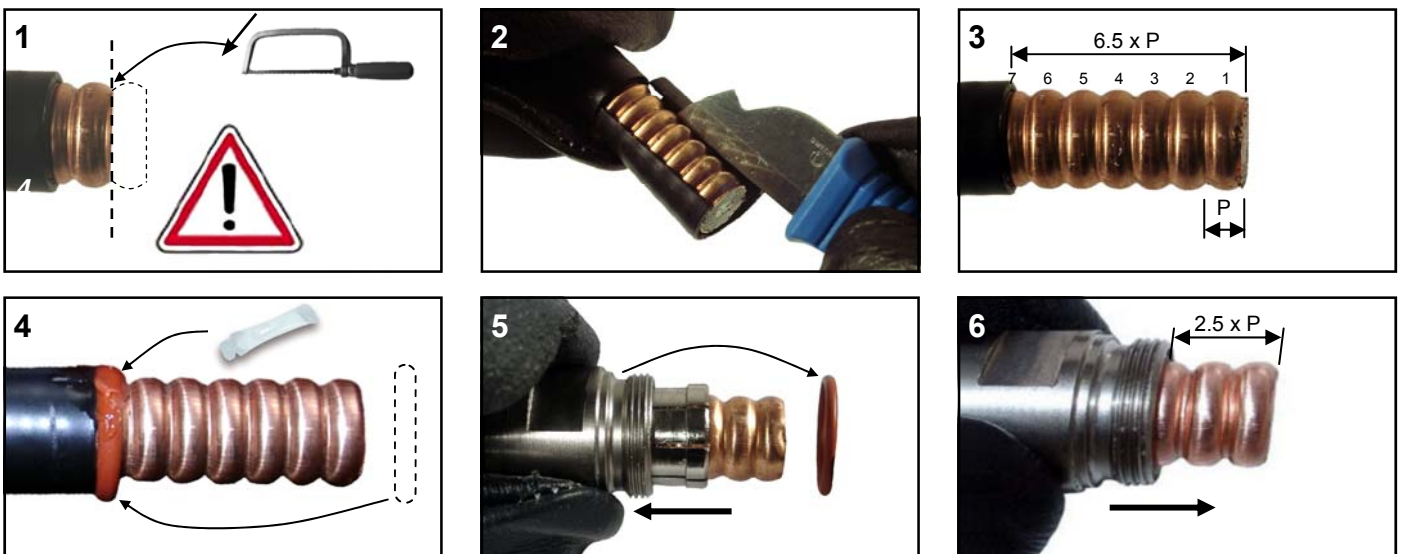



# INSTALLATION INSTRUCTION

## 50 Ohm CONNECTORS

Kabelwerk **EUPEN** AG

E1018 Rev.17/2025-10-09

cable

2/2

### 1/2" - Straight & right angle connectors - O-Ring type

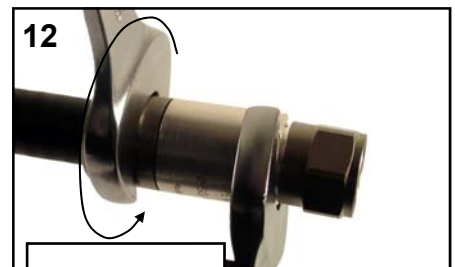
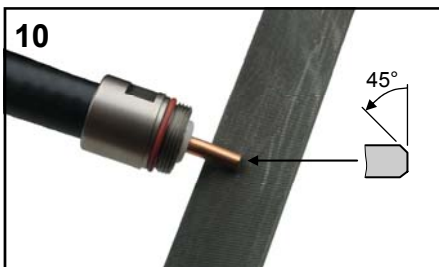
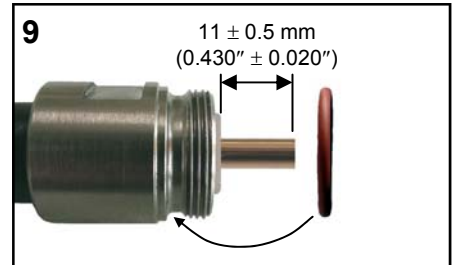
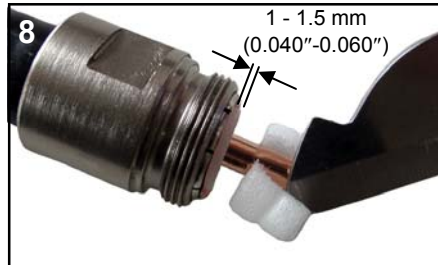
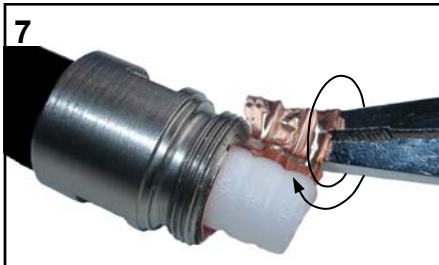

For any questions please contact KABELWERK EUPEN AG / for US Customer service call 1-800-419-5100

**(D)** Verarbeitung nur durch eine Elektrofachkraft.  
Es besteht die Gefahr eines elektrischen Schlages!

**(F)** Installation uniquement par une personne qualifiée en électricité.  
Il y a un risque de choc électrique!



**(NL)** Installatie alleen door een vakman voor elektriciteit.  
Er is gevaar van elektrische schok!

**(GB)** Processing only by a qualified electrician.  
There is a risk of electric shock!

**NOTICE:**  
KABELWERK EUPEN AG  
disclaims any liability or  
responsibility for the results  
of improper or unsafe installa-  
tion practices.

**AVIS:**  
KABELWERK EUPEN AG  
décline toute responsabilité  
en cas de non respect de  
ces instructions.

**WAARSCHUWING:**  
KABELWERK EUPEN AG  
wijst elke verantwoordelijk-  
heid van de hand in geval  
van het niet opvolgen van  
deze aanbevelingen.

**BEMERKUNG:**  
KABELWERK EUPEN AG  
lehnt jede Verantwortung bei  
Nichtbeachtung dieser  
Instruktionen ab.

**AVISO:**  
KABELWERK EUPEN AG  
rehusa todas las responsabi-  
lidades en caso de no  
respetar las instrucciones.

**注意:**  
本公司声明对于不恰当或不  
安全的安装, 检验, 维修或拆  
卸操作所导致的后果不负任  
何义务和责任。